

CROPPER CLOSE



TO LET 5,000 - 12,000 sq ft



QUALITY NEW BUILD INDUSTRIAL PREMISES

7.5m to eaves / 9m to ridge with mezzanine option
Large secure yard for HGV access and parking
High speed fibre to premises data connection

4 & 5 CROPPER CLOSE, WHITEHILLS BUSINESS PARK, BLACKPOOL FY4 5PU



WHITEHILLS BUSINESS PARK

		GROUND FLOOR	MEZZANINE OPTION
UNIT 3	LET	8,350 sq ft	1,800 sq ft
UNIT 4	AVAILABLE	5,070 sq ft	up to 3,000 sq ft
UNIT 5	AVAILABLE	6,930 sq ft	up to 3,000 sq ft

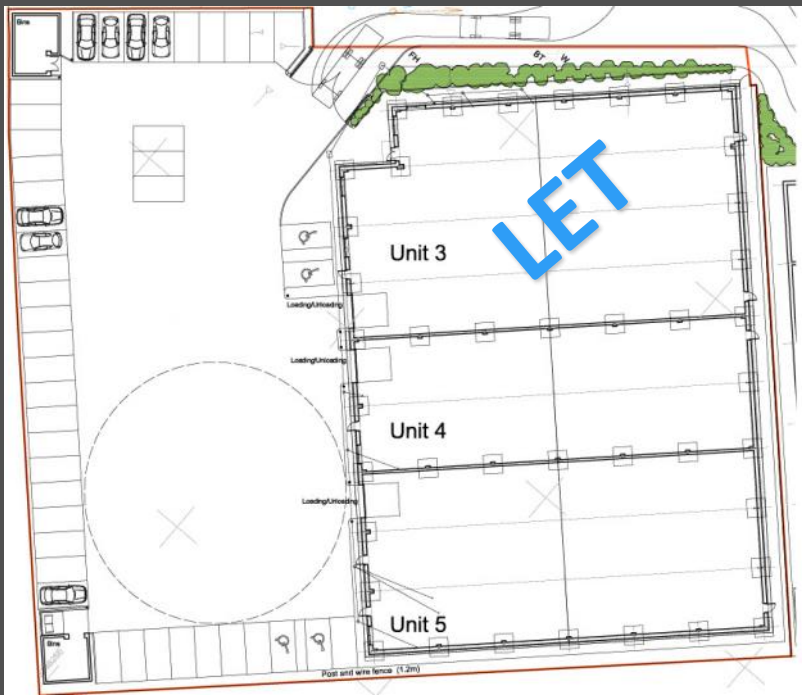

Cropper Close is located on the prestigious Whitehills Business Park - the geographic centre of the Fylde Coast and adjacent to J4 of the M55.

A new development of 3 high quality industrial units:

- 7.5m to eaves / 9m to ridge with mezzanine options
- Large yard with 25m turning circle and ample parking
- 3 phase electric supply and fibre to premises data connection
- Available as separate units or c.12,000 sq ft combined
- Available fully fitted or to shell specification as seen

HENCO
INTERNATIONAL
WWW.HENCO.CO.UK

Office: 01253 832 333
Email: chibbert@henco.co.uk
Mobile: 07745 555 005

Misrepresentation Act: All agents for themselves and for vendors or lessors of these properties whose agents they are give notice that: (i) the particulars are set out as a general outline for the guidance of intended purchasers or lessees, and do not constitute part of, an offer or contract; (ii) all descriptions, dimensions, reference to condition and necessary permissions for use and occupation, and other details are given without responsibility and any intending purchasers or tenants should not rely on them as statements or representations of fact but must satisfy themselves by inspection or otherwise as to the correctness of each of them; (iii) no person in the employment of the agents has any authority or give any representation or warranty in relation to this property.