

**NOTES**

- This drawing is copyright. No unauthorised copying of drawing without the express permission of the architect.
- Do not scale from prints. Use figure dimensions only.
- Contractors to check all dimensions on site prior to commencement of works.
- All works to be carried out in accordance with current statutory Health and Safety Regulations.
- This drawing is to be read in conjunction with all relevant consultants' and / or specialists' drawings / documents and any discrepancies or variations are to be notified to the architect before affected work commences.

REV.	AMENDMENTS	DATE
Rev A	Ground floor Meeting Room & Warehouse Manager office added to Unit A.	19-10-27
Rev B	Windows and doors altered, layout of Building B altered and additional dims added	19-11-06
Rev C	Fit-out areas indicated	19-11-19
Rev D	New Mezz layout for Unit A	19-12-13
Rev E	Revision to Mezz layout for Unit A	19-12-13
Rev F	Revision to Mezz layout for Unit A	19-12-20
Rev G	Revision to Mezz layout for Unit A	19-12-31
Rev H	Building divided into three Units	20-01-09
Rev J	Internal amendments to unit B	20-01-09
Rev K	Unit A windows removed from toilets & rest room	20-01-09
Rev L	All doors on grid line 2 now opening inwards	20-03-06
Rev M	Bld A. Meeting room removed, kitchen and Comms room added	20-06-22

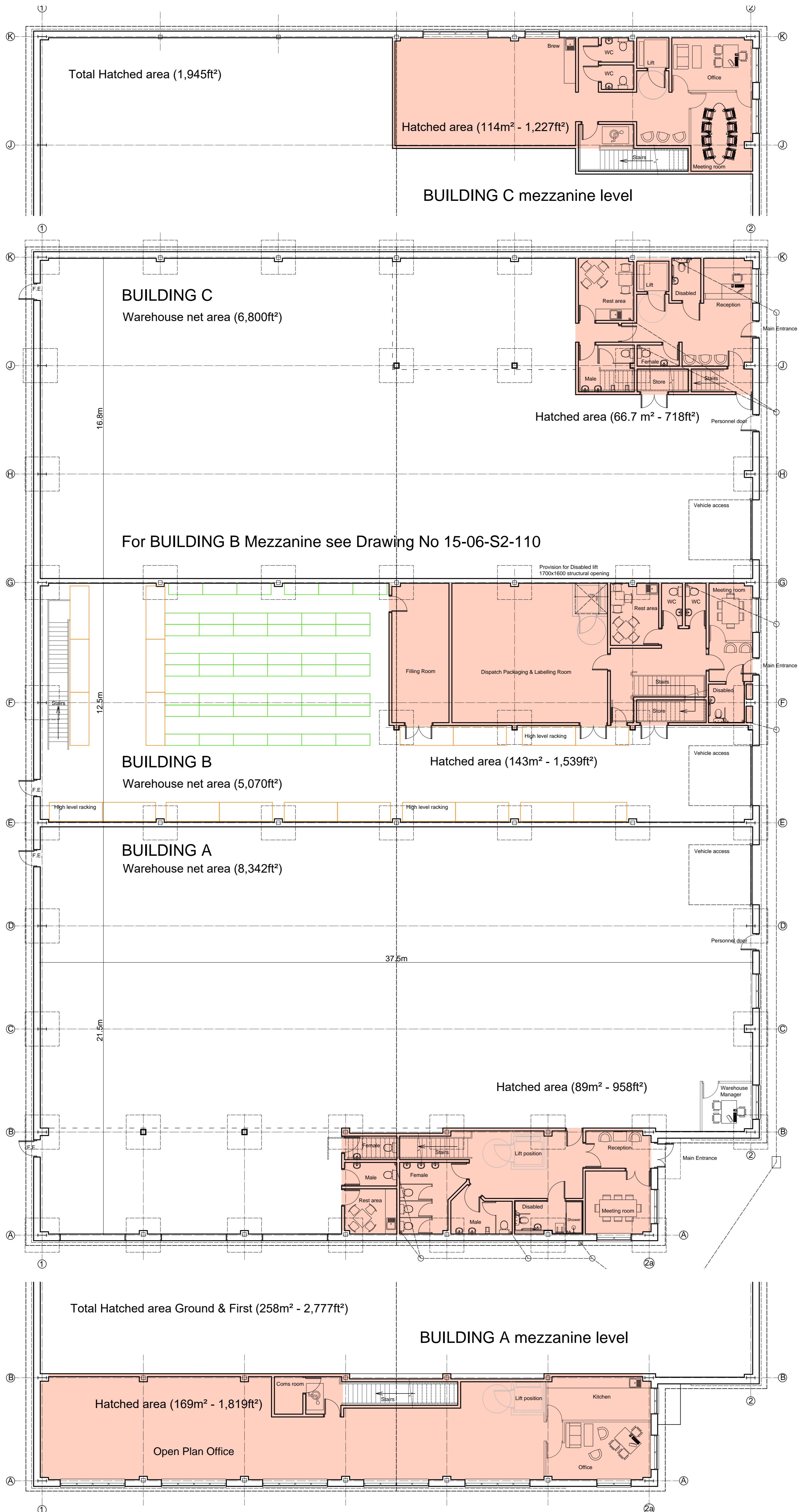

Project	WHITEHILLS BUSINESS PARK SITE 2
Drawing	PROPOSED BUILDING A,B & C FLOOR PLANS
Client	HENCO INTERNATIONAL LTD
Dwn. By	NP
Scale	1:100 @ A1
Drg. No.	15-06-S2-105-M
Drg. Size	A1
Date	OCTOBER 2019