

Business Unit 2 Ground Floor Plan

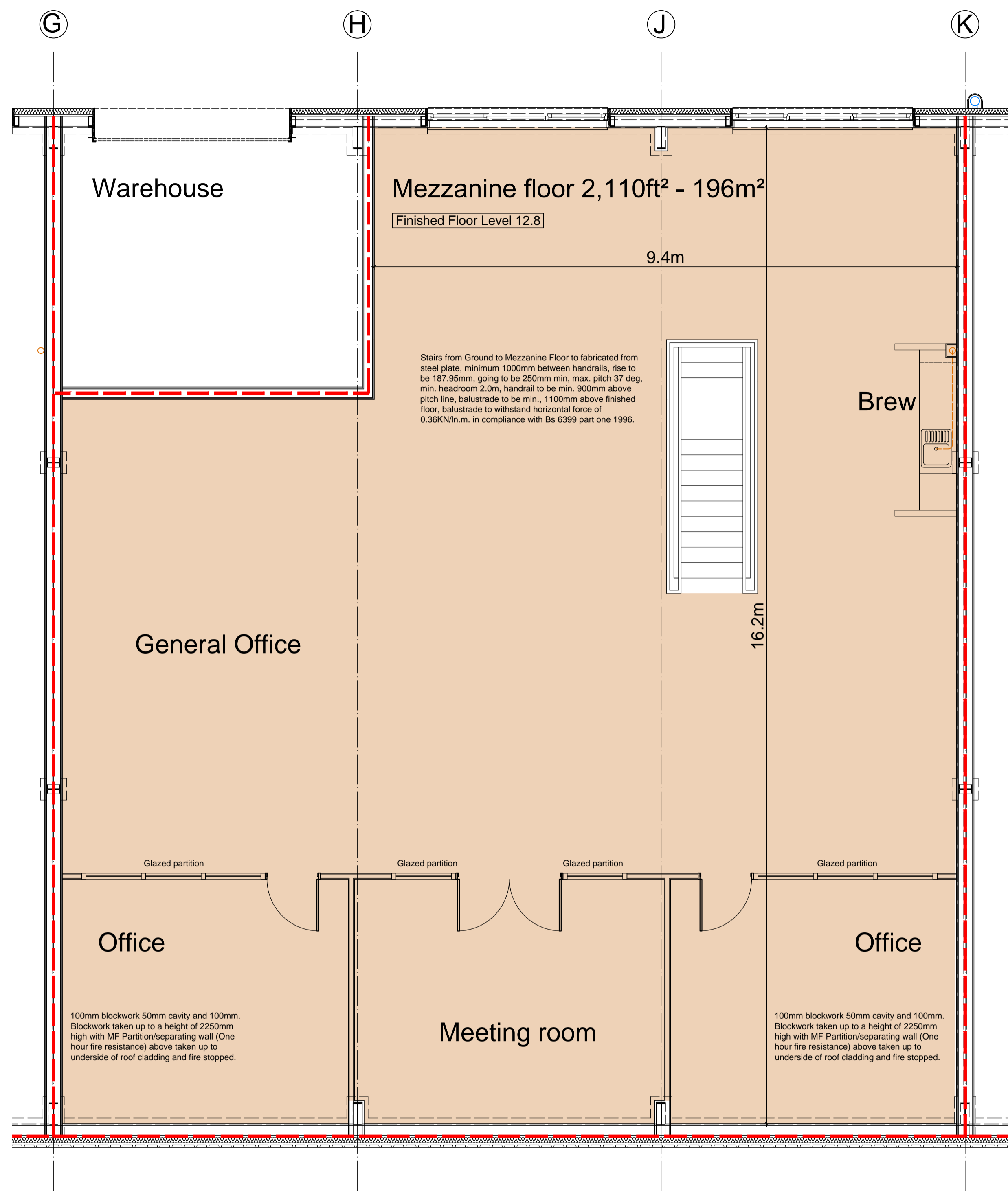

Business Unit 2 Mezzanine Floor Plan

- NOTES**
- This drawing is copyright. No unauthorised copying of drawing without the express permission of the architect.
 - Do not scale from prints. Use figure dimensions only.
 - Contractors to check all dimensions on site prior to commencement of works.
 - All works to be carried out in accordance with current statutory Health and Safety Regulations.
 - This drawing is to be read in conjunction with all relevant consultants' and / or specialists' drawings / documents and any discrepancies or variations are to be notified to the architect before affected work commences.

REV.	AMENDMENTS	DATE
Rev A	Amendments to mezzanine floor & ancillary facilities	16-03-18
Rev B	Toilets moved to ground floor	16-03-20

BUILDING NOTES

FOUNDATIONS: for Foundation details see Engineers drawings.
STEEL FRAME: for Steel frame details see Engineers drawings.

All steelwork within the external cavity wall construction is to receive two coats of bituminous paint prior to construction of cavity wall
 All steelwork supporting compartment floors and fire separating walls are to be protected with fireline board or Intumescent paint taken up to the roof level. Protection to be a minimum of one hour fire resistance.

GROUND FLOOR CONSTRUCTION: 150mm min thickness concrete on 50mm thick Kingspan Kooltherm on 1200g visqueen DPM on 50mm min thickness sand blinding on 150mm min thickness well compacted hardcore. All to achieve minimum U value of 0.22W/m²K See Engineers details.

MASONRY CAVITY CONSTRUCTION: 100mm thick brickwork external leaf 130mm wide cavity with 65mm thick Kingspan Kooltherm partial fill insulation board, held firmly in place with cavity ties and maintaining a min 50mm clear cavity with 100mm medium density concrete block inner leaf. All mortar joints to be fully sealed "no gaps". All to achieve minimum U value of 0.22W/m²K
 Position of Brickwork movement joints to be in accordance with PD 6697 and agreed with Structural Engineer & Architect.
 Stainless steel brick ties at 750mm centres horizontally and 450mm vertically staggered and to every block course vertically at reveals. Engineer to confirm.

WALL CLADDING: Horizontal Mircorib profiled steel composite cladding, 90mm o/a thickness supported on steel cladding rails and structural steel frame all to achieve minimum U value of 0.24W/m²K

Vertical profiled metal composite cladding 215mm o/a thickness supported on steel cladding rails and structural steel frame all to achieve minimum U value of 0.24W/m²K.

ROOF CLADDING: Profiled steel composite cladding, 150mm o/a thickness supported on steel cladding rails and structural steel frame all to achieve minimum U value of 0.16W/m²K

DRAINAGE: for foul and surface water drainage falls, specification and details see Engineers drawings

WINDOWS & DOORS: Thermally broken PPC Aluminium window & door frames dimensions are indicative and site measurements are required prior to any fabrication.

- Brickwork & Blockwork cavity wall with insulation
 - Vertical Profiled metal composite cladding
 - Horizontal Mirorib Profiled metal composite cladding
 - MF partition
 - Indicates One Hour Boundary Firewall condition & One Separation
 - Fire door, 30mins resistance with smoke seals and self closer
- All steelwork supporting compartment floors and fire separating walls are to be protected with fireline board or Intumescent paint taken up to the roof level. Protection to be a minimum of one hour fire resistance.
- One hour fire resistant fire collars and dampers are required to all penetrations greater than 55mm in diameter through compartment floors and walls.
- The Emergency Lighting is to be designed and installed in accordance with BS 5266-1:2011
 The Fire Alarm is to be designed and installed in accordance with BS 5839-1:2013

Business Unit 2 Ground Floor & Mezzanine Floor Plans @ 1:50

Project	OFFICES & BUSINESS UNITS DEVELOPMENT AT HALLAM WAY, WHITEHILLS BUSINESS PARK
Drawing	BUILDING REGULATIONS - BUSINESS UNIT 2 PROPOSED GROUND & MEZZ FLOOR PLANS
Client	HENCO INTERNATIONAL LTD
Dwn. By	NP
Scale	1:50
Drg. No.	14-08-418-B
Drg. Size	A1
Date	MARCH 2016