

POSTAL NUMBERS AND ADDRESSES

POSTAL ADDRESS:

APOLLO HOUSE
HALLAM WAY WAY
WHITEHILLS BUSINESS PARK
BLACKPOOL

TALISMAN HOUSE
BOARDMANS WAY
WHITEHILLS BUSINESS PARK
BLACKPOOL

APOLLO COURT NOS 7 TO 11
HALLAM WAY
WHITEHILLS BUSINESS PARK
BLACKPOOL

CROPPER CLOSE

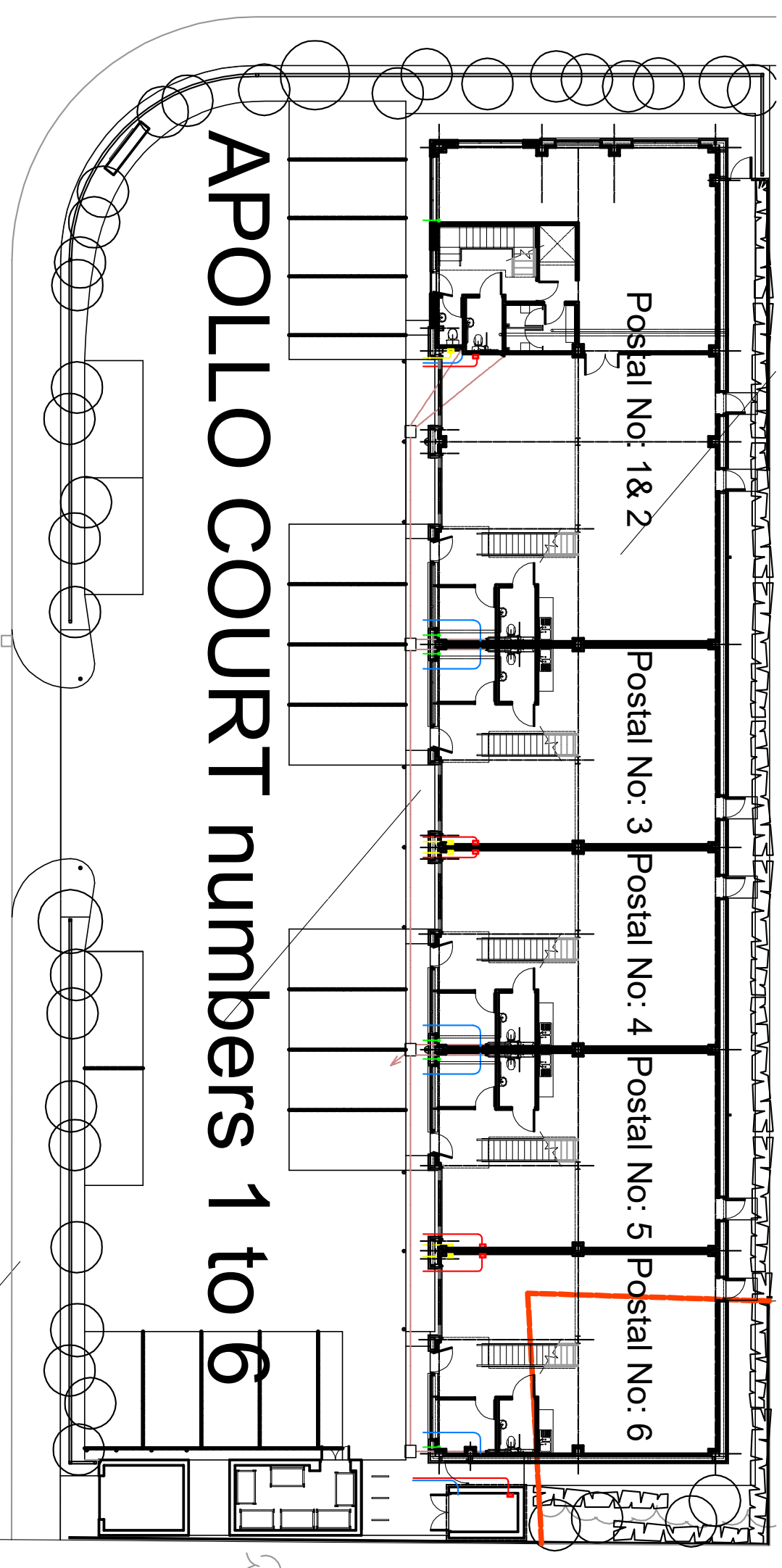

HALLAM WAY



BARROW CLOSE

NOTES

- This drawing is copyright. No unauthorised copying of drawing without the express permission of the architect.
- Do not scale from prints. Use figure dimensions only.
- Contractors to check all dimensions on site prior to commencement of works.
- All works to be carried out in accordance with current statutory Health and Safety Regulations.
- This drawing is to be read in conjunction with all relevant consultants' and / or specialists' drawings / documents and any discrepancies or variations are to be notified to the architect before affected work commences.

| REV. | AMENDMENTS | DATE |
|------|------------|------|
| | | |

| | |
|-----------|---|
| Project | HENCO PHASE TWO DEVELOPMENT WHITEHILLS BUSINESS PARK PROPOSED POSTAL NUMBERS PLAN |
| Client | HENCO INTERNATIONAL LTD |
| Dwn, By | NP |
| Scale | NTS |
| Dwg. No. | 14-08-17 |
| Dwg. Size | A2 |
| Date | SEPTEMBER 2015 |